



HYDAC Technology Corporation

2260 City Line Road,

Bethlehem, PA 18017

TOLL FREE: [877-GO-HYDAC \(464-9322\)](tel:877-GO-HYDAC)

Website: www.hydac-na.com

VMF-VR: Low Pressure / Return Type C: Electrical Switch

Early warning pressure devices protect the hydraulic circuit from contamination, alerting the operator that the filter element is near capacity and must be changed. The clogging indicator is typically set to trip at 1-bar (14 psid) below the filter bypass setting, to allow the operator sufficient time for element change-out. Available in visual, combo electrical/visual, as well as an extensive list of other options and certifications. A comprehensive offering of clogging indicators ensures that

[+ more](#)

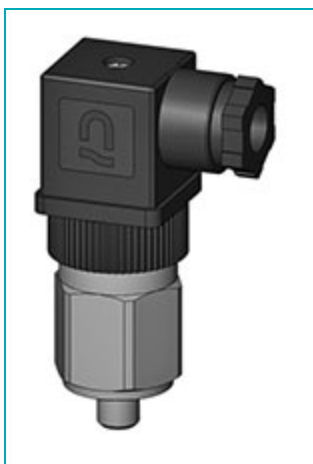

1

Part Number	Model Code Description	Type of Indication	Trip Pressure / Range	Thread	Medium	Maximum Torque
2072740	VMF1.4C.1/3	Electrical Switch	1.4 bar 20 psi	G 1/8	Mineral Oil or Water Based Fluids	11 lb·ft 15 N·m
2089168	VMF1C.1/3	Electrical Switch	1 bar 15 psi	G 1/8	Mineral Oil or Water Based Fluids	11 lb·ft 15 N·m

Part Number	Model Code Description	Type of Indication	Trip Pressure / Range	Thread	Medium	Maximum Torque
<u>1253352</u>	VMF2.5C.1	Electrical Switch	2.5 bar 36 psi	G 1/8	Mineral Oil or Water Based Fluids	11 lb·ft 15 N·m
<u>306579</u>	VMF2C.1	Electrical Switch	2 bar 29 psi	G 1/8	Mineral Oil or Water Based Fluids	11 lb·ft 15 N·m
<u>2078538</u>	VMF2C.1/3	Electrical Switch	2 bar 29 psi	G 1/8	Mineral Oil or Water Based Fluids	11 lb·ft 15 N·m
<u>1297956</u>	VMF3C.1	Electrical Switch	3 bar 43 psi	G 1/8	Mineral Oil or Water Based Fluids	11 lb·ft 15 N·m
<u>1260429</u>	VMF5C.1	Electrical Switch	5 bar 72 psi	G 1/8	Mineral Oil or Water Based Fluids	11 lb·ft 15 N·m
<u>1285428</u>	VR 2 C.0 /- CSA	Electrical Switch	2 bar 29 psi	G 1/2	Mineral Oil or Water Based Fluids	22 lb·ft 30 N·m
<u>1281866</u>	VR 2.5 CM.1/-4M0	N/A	2.5 bar 36 psi	G 1/2	Mineral Oil or Water Based Fluids	N/A
<u>304204</u>	VR0.8C.0	Electrical Switch	0.8 bar 11 psi	G 1/2	Mineral Oil or Water Based Fluids	22 lb·ft 30 N·m
<u>1260158</u>	VR2C.0/- EX2G	Electrical Switch	2 bar 29 psi	G 1/2	Mineral Oil or Water Based Fluids	22 lb·ft 30 N·m

Part Number	Model Code Description	Type of Indication	Trip Pressure / Range	Thread	Medium	Maximum Torque
<u>306823</u>	VR2C.1	Electrical Switch	2 bar 29 psi	G 1/2	Mineral Oil or Water Based Fluids	22 lb·ft 30 N·m
<u>306831</u>	VR2C.1/V	Electrical Switch	2 bar 29 psi	G 1/2	Mineral Oil or Water Based Fluids	22 lb·ft 30 N·m
<u>303757</u>	VR5C.1	Electrical Switch	5 bar 72 psi	G 1/2	Mineral Oil or Water Based Fluids	22 lb·ft 30 N·m
<u>317833</u>	VR5C.1/-V	Electrical Switch	5 bar 72 psi	G 1/2	Mineral Oil or Water Based Fluids	22 lb·ft 30 N·m
<u>2077819</u>	VR6C.0	Electrical Switch	6 bar 87 psi	G 1/2	Mineral Oil or Water Based Fluids	22 lb·ft 30 N·m